

**09 NIGHT / 10 DAY'S (Ex. Chandigarh OR Ambala)****HIMACHAL WITH AMRITSAR**





( Chandigarh - Shimla - Manali - Dharamsala - Dalhousie - Amritsar )

01 Night Chandigarh - 01 Night Shimla- 03 Night Manali - 01 Night Dharamsala (Chamunda Ji) - 02 Night Dalhousie - 01 Night Amritsar

206, SAIGIRI APARTMENT, SAIBABA NAGAR, NAVGHAR ROAD, BHAYANDER(E), MUMBAI - 401105

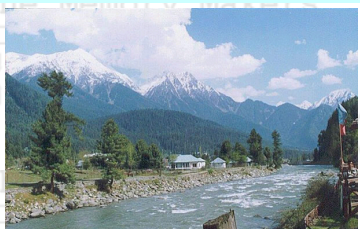
**Phone: - 9321590898 / 9322590898**

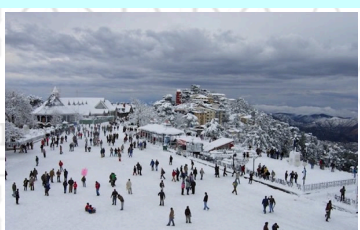
Website - www.kanaiyatravels.com / Email - kanaiyatravels@gmail.com

Days	Tour Detail	SPECIAL DISCOUNT ON GROUP BOOKING
Day 01 :	<b>ARRIVE - AMBALA OR CHANDIGARH</b> Arrive Ambala railway station and proceed to Chandigarh (2 Hrs). OR Arrive Chandigarh Airport and Transfer to Hotel. After Lunch visit Rock Garden, Sukh Sagar Lake, Rose Garden & Pinjore Garden. Overnighgt Chandigarh.	<b>DEPARTURE DATE</b>
Day 02 :	<b>CHANDIGARH - KUFRI - SHIMLA (120 KM)</b> After Breakfast Drive to Kufri (5 -6 Hrs), visit Kufri By Horse, enjoy horse riding . Back Shimla at noon. Evening free time for shopping at Mall Road. Overnight Shimla.	<b>DAILY DEPARTURE</b>
Day 03 :	<b>SHIMLA - KULU - MANALI (280 KM / 10 Hrs)</b> After B/F start for Manali situated on 5500 feet. Height, Lunch on the way, Enroute visit Vaishnodevi Temple at Kullu, Arrive Manali, Check into the Hotel, Overnight Manali.	 <b>KHAJJJAR</b>
Day 04 :	<b>MANALI - SOLANG VALLEY - MANALI (30 KM RETURN)</b> After breakfast visit Solang Valley is also known as the 'Snow Valley' which is famous for hosting various adventure sport activities like Skiing, Parachuting, Paragliding, Trekking and Mountaineering (at your own cost). This Dazzling valley is one of the most picturesque sights in Manali. Enjoy Ski Himalayan Cable Car Ride (at your own cost). Evening free time for shopping on Mall road. Night halt at Manali.	 <b>BEAS RIVER VEIW</b>
Day 05 :	<b>MANALI</b> After B/F local sight seen like Vashishta Bath- The hot water sulphur spring, ancient Hedamba Temple, Back to Hotel, Lunch, Rest of the day free for leisure, <b>Overnight Manali.</b>	 <b>WAGAH BORDER</b>
Day 06 :	<b>MANALI - KULU - DHARMSALA / CHAMUNDAJI (210 KM)</b> Early and after breakfast proceed for Dharamsala,(8 - 9Hrs), Enroute enjoy River Rafting (Self Expense), and Also Visit Kulu Shawl Factori . After arrive visit Dalai Lama Temple, And Chamundaji Temple. <b>Overnight Dharamsala / Chamundaji.</b>	 <b>SNOW POINT</b>
Day 07 :	<b>CHAMUNDAJI - DALHOUSIE (170 KM)</b> After B/F start for Dalhousie (App. 170 Kms. / 7-8 Hrs.) situated on 5500 ft. height, Lunch on the way, Arrive Dalhousie, Check into the Hotel, <b>Overnight Dalhousie.</b>	 <b>SNOW POINT</b>
Day 08 :	<b>DALHOUSIE - KHAJJJAR - DALHOUSIE (44 KM RETURN)</b> After B/F start for Khajjiar popularity called the Mini Switzerland where you can enjoy the Horse Riding (Self Expense), Back to the Hotel, Lunch, Rest of the day free for leisure, <b>Overnight Dalhousie.</b>	
Day 09 :	<b>DALHOUSIE - GOLDEN TEMPLE - WAGAH BORDER - AMRITSAR (180 KM)</b> Early Morning (6.00AM) after breakfast leave for Amrutsar. (5 Hrs). Light Lunch Enroute, Arrive Amrutsar & visit Golden Temple , Histroricle Jaliawala Bagh and Evening Enjoy Ind - Pak Military Pared on Wagha Border. After Visit Transfer to Hotel. <b>Overnight Amritsar.</b>	
Day 10 :	<b>DROP TO AMRITSAR RAILWAY STATION</b> After breakfast Drop to Amritsar Railway Station / Airport to board the Train / Flight. <b>Tour End With Memoreble mamories With Shree Kanaiya Tours &amp; Travels.</b>	

- Book your flights / Trains to arriving at Ambala / Chandigarh at till afternoon & Return at moning to afternoon from Amritsar.
- On Tour Guests are requested to carry 2 Passport Size Photo + Original & 2 photo copy (xerox) of any Photo ID proof (Except Pan Card) i.e. Passport / Driving Licence / Voter's ID along with them. Also submit a copy of the same at the time of booking.
- This Tour starts with Dinner on Day 1 and Ends with Breakfast on Day 10, .
- All Mobile Network operates Available in Himachal & Punjab.
- Rohtang pass is 51 kms Away from Manali. This Pass is accessible from May to June & Oct. -to- Nov. and rest of time it's closed for almost 8 months in a year as it is covered by snow. We generally visit the solang Valley, Gulaba Or Madhi. Rohtang pass is closed on every Tuesday for Maintaince purpose.As per High court order entry of vehicles is restricted to Rohtang Pass,daily 1,000 entry permit are issued to local taxis which is subject to availability.
- Room Heater available with an extra cost bourne by the guest directly.
- We would appreciate, if the guest does not lend their ears to the drivers as most of the time they misguide the passengers. In such instances we would request them to contact our executive.
- Climate in Himachal is not predictable so you need to carry winter, summer & monsoon wears - Thermals, Pair of Gloves, Monkey Cap, Cotton, Sweater, Sun's Screen & Winter lotions (available in Leh local markets), lip balm, Sun glasses, Sports Shoes, Umbrella/Windcheater, Vicks, Camphor, Nilgiri etc.
- Carry your Regular Basic medicines & Basic First Aid Kit with you.
- You may be cheated into horse riding, shopping and sporting activity, so you should be careful.

**: TOUR COST - PER PERSON - WITH BREAKFAST & DINNER (MAP PLAN - Hotels Food ) :  
: Ex. AMBALA CANTT OR CHANDIGARH & AMRITSAR (Without Any Train & Air Fare) :**

Tour Cost - Per person On Twin Sharing Basis With Breakfast & Dinner	Tour Cost - Per Person With Sedan Car for Family (2 To 4 Pax) Scorpio , Xylo, Innova, for 4 To 7 Pax			Tour Cost - Per Person With Tempo Travellers For 8 to 12 Pax			Tour Cost For Extra Adult OR Child With & Without Extra Bed / Mattress		
	Minimum 2 Pax Then	Minimum 4 Pax Then	Minimum 6 Pax Then	Minimum 8 Pax Then	Minimum 10 Pax Then	Minimum 12 Pax Then	Child OR Adult With Extra Bed	Child Without Extra Bed 5 to 11 Years	Below 5 Years Without Bed
Super Deluxe Tour With Breakfast & Dinner	Rs. 43,001	Rs. 34,501	Rs. 28,501	Rs. 29,001	Rs. 28,001	Rs. 27,501	Rs. 22,001	Rs. 12,001	FREE
Super Deluxe Luxury Tour With 4 Star Hotels & With Breakfast & Dinner	Rs. 55,001	Rs. 47,001	Rs. 43,000	Rs. 43,501	Rs. 42,501	Rs. 41,501	Rs. 29,501	Rs. 21,501	FREE

**: DESTINATION & HOTELS NAME:**

Destination	Super Deluxe Tour - Hotel Name (With Breakfast & Dinner)	Super Deluxe Best Luxury Tour - Hotel Name (With Breakfast & Dinner)
Chandigarh :	Hotel Classic Residency / Sunpark / Marc Royale / Clarion Inn / Similar	Best Western Maryland / Clarion Inn Savilla / Clarks Inn Velvet Exotica / Similar
Shimla :	Shukhsagar Regency / Satyam Paradise / D Park / hotel Himdev / Similar	Ashiana Clarks inn / The Royal Regency / East Bourne / Similar
Manali :	Hotel Snow Park / Sun Park / Manali Grand / Hotel Natraj / Snow View / New Kelinworth / Similar	Life Style Manali / The Orchard Greens / Rohtang Heights / Renest River Country / Citrus Manali Resort / Similar
Dharamsala / Chamunda Ji :	Hotel Vatika (Chamunda) / Anupam Resort / Sky Heavan Resort / Ess & Bee Resort / hotel Him Queen / Similar	Imperial Clarks Inn / Pride Surya / Indraprastha Resort & Spa / Similar
Dalhousie :	Hotel Kumar / New Palace / Namaskar / Bear Valley / Similar	Hotel Grand View / Mount View / Snow Valley Resorts / Dalhousie Heights / Similar
Amritsar :	Hotel Ishita / Kishor International / Hotel R V Continental / Hotel Puri Palace / Namaskar Heights / Similar	Hotel Golden Tulip / Hotel Park Inn / Radisson Blu / Hotel Mohan Palace / Similar

**TOUR COST INCLUSIONS & TOUR COST EXCLUSIONS**

TOUR COST INCLUDES	TOUR COST EXCLUDES
<ul style="list-style-type: none"> <li>As per Your decided Package &amp; plan Transfers and sightseeing will be done by Non AC Swift Desire / XCent / Etios for 2 to 3 person - Xylo / Scorpio / Innova for 4 to 7 person and Tempo Traveler for 8 to 14 person. (AC will not work in hilly areas, traffic jams, parking, and stoped vehicle.)</li> <li>Toll, parking, Driver bata, interstate permit &amp; fuel Cost,</li> <li>Twin / Tripple sharing accommodation in Economi Hotel / Deluxe Hoel / Super Deluxe Hotels as For By Your decided Package &amp; plan.</li> <li>Extensive sight seeing as per the Tour programme.</li> <li>09 Breakfast &amp; 09 Dinner (From Hotel Fix Menu).</li> </ul>	<ul style="list-style-type: none"> <li>Train / Air fare, Insurance. GST , TCS (Government Service Tax)</li> <li>Rohtang Pass Permit &amp; Shimla Mall Road Taxi Fare.</li> <li>Guide &amp; Any Sports Activities Charges during sightseeing.</li> <li>Horse Riding, Yak Riding, Room Heater, Ropway Cable Car, Sports, Boating, Garden Entry Fees, Rafting, PhotoGraphi, Any Type Of Safari, Ice Sports, Etc.</li> <li>Personal expenses such as Cold Drinks, Mineral Water, laundry Charges, Telephone Call, Coolie Charges.</li> <li>Any other expenses which in not specifically included in the "TOUR COST INCLUDES.</li> <li>Any Texi / Auto Fare For Local Sightseeing. (If Our Vehicle Is Not Allowed)</li> </ul>

**Note :- Before Booking the Tour Please Read Terms & Condition carefully.**

- You can confirm your booking in our Tour by paying a deposit of Rs. 15,000/- per person out of this Rs. 10,000/- is non refundable and non transferable & Balance payment by Cheque / Cash will be excepted 15 days prior to the departure of the Tour. If anybody fails to pay the balance amount before 15 days, he shall be deemed as cancelled and the deposit shall not be refunded.
- In 3/4 Sharing occupancy, 1 double bed and only 1 Extra Mattress provide on ground in one room.,
- AC will not work on vehicle in hill areas or stopped / parked/ Traffic Jam.
- At Hotel Check-in time is 12.30 PM & Check-out time 10.30 AM, Early check in and late checkout In Hotel subject to availability.
- We are not liable for any kind of refund for any damage caused by any disturbance such as riots, accidents, floods, cyclones, rains, landslides, political unrest, shutdown of India, or any natural or man-made disaster. (Eg .. flight tickets, train tickets, hotel booking, vehicle booking, wastage of days, food, sightseeing, injury and death, theft, robbery etc.)
- Audio Video system provided in vehicle is complimentary, we do not charge anything extra for that and hence, in case the audio or video is not working, is not in the vehicle or stops working during Tour NO AMOUNT CAN BE DEDUCTED FROM OUR BILL.
- Tourists travel at their own risk. The tour operator or their representative or staff will not be responsible in any way for any loss, injury, accident, death etc.
- We act only as agents for transporters and while exercising the greatest possible care to give the best services, cannot be held reasonable for any liabilities arising during the use of vehicles for which the transporter is responsible.
- In any situation if a passenger needs to leave a Tour package midway then no refunds would be given. Any passenger who does provoking activities in the Tour and disturbs the management of the Tour will be excluded from the Tour and no refund would be given for the same.
- Railway / Air / Helicopter Ticket, insurance premium, porter-charges, horse carriage, stretcher charges, rope-way, laundry, Guide Fees, Entrance fees, boat, Rop - Way Ticket, Any Garden - Museum , Killa Entree Ticket, , Rafting , Any Sport Activites, Jungle Safari, donations and alms, Room Heater, Medicines or Expenses done for personal choices will be borne separately by the Tourist.
- Shree Kanaiya Tours & Travels will not be responsible if the flight / Train is delayed or cancelled.

**Easy Cancellation (But we actually don't want you to see this - We believe you deserve holidays..)**

- Before 30 Days, of Tour Departure - Rs. 10000/- + GST + Flight / Train Ticket Cancellation Charges per person
- Between 15 to 30 Day - 50% of the Tour Cost + GST + Flight / Train Ticket Cancellation Charges per person
- Within 15 days - 100% of the Tour Cost. + Flight / Train Ticket Cancellation Charges per person

## :- Why book only with Shree Kanaya Travels ?

- Shree Kanaya Travels is the address of faith.
- The question why one should enroll with Shree Kanaiya Travels, is answered by all our ex – clients as to get the personal touch, courteous service , commitment towards our clients, honesty & transparency in business, innovations and last but not the least – family atmosphere on the tour. Once a person travels with us, he becomes our lifelong family member ... Which is one of our USPs!
- More than 25 years experience in the Travels Industry.
- More than 350,000 100% satisfied travelers.
- More than 90% + frequent and regular tourists
- Special attention of senior citizens and children.
- Organization of entertainment programs like Games, DJ, Garba & Campfire during the tour.
- Award `s winner of Best and Leading Tour Operator for Domestic (India) Tourism.
- Shree Kanaiya Travels offer good and clean and great Super deluxe best hotels with good location throughout the tour.
- Sir ... you are entrusting me with faith to make your beloved family happy and that is an invaluable and proud thing for me. I will never break that trust so if you really want to enjoy the journey, trust us and do not fall into any temptation, you have to spend the right and proper money to enjoy your family travel.
- We guarantee hassle free and enjoyable experience at all times.

### Hotel Photos for Super Deluxe Tour ( Hotel Tariff Approx Rs. 3800/- To 4200/- Per Day / Per Room With Breakfast & Dinner)



### Hotel Photos for Super Deluxe Luxury Tour ( Hotel Tariff Approx Rs. 6500/- To 7000/- Per Day / Per Room With Breakfast & Dinner)

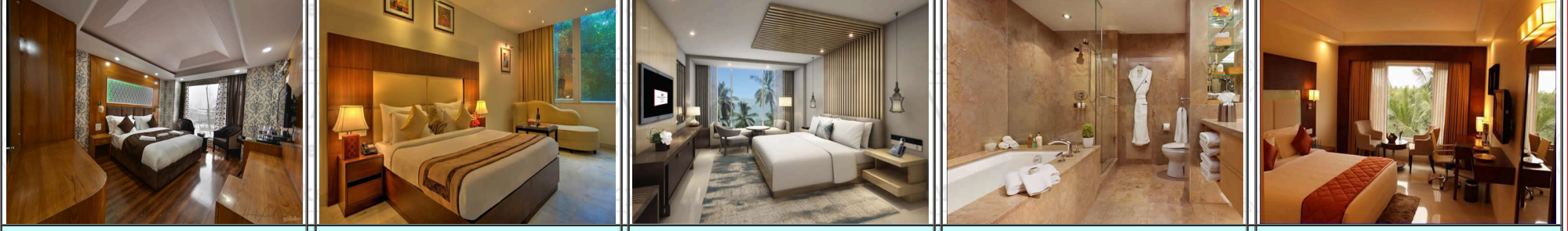

### VEHICLE PHOTOS



Innova

Innova Seat

Tempo Traveller

Tempo Traveller Seat

Tempo Traveller Seat

**!!! ENJOY YOUR HOLIDAYS ONLY WITH SHREE KANAIYA TOURS & TRAVELS !!!**